

*Gilmore Cemetery, Le Roy, Illinois*

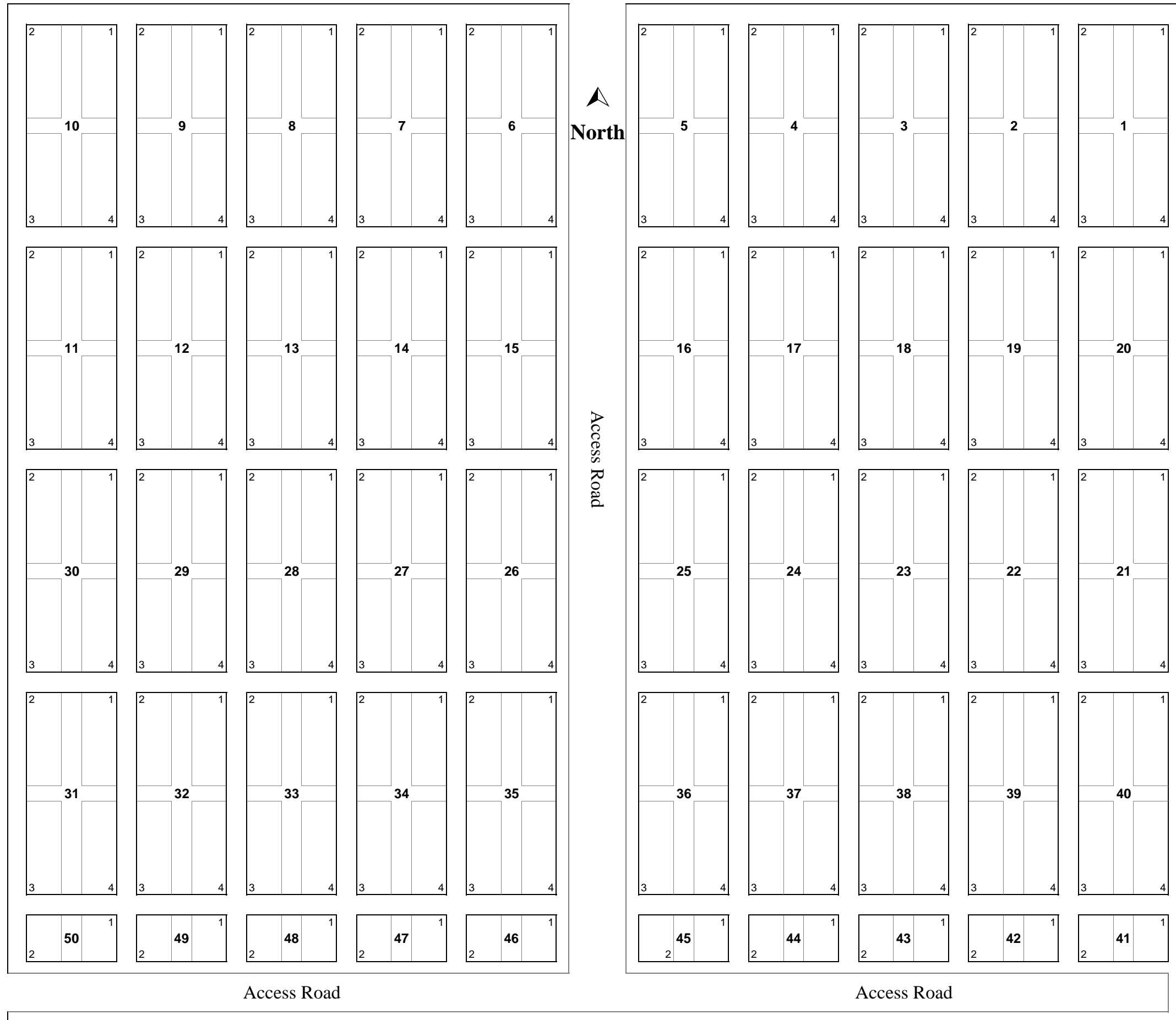

ENTRANCE

R.W. MOORE

LOUISA E. MORGAN HILL  
B-1855-1937  
REBECCA MOORE  
1864-1932  
P. W. MOORE  
1849-1932  
HANNAH G. wife  
B-2-11-1818 D-2-13-1890

VAULT  
JAMES HANSON  
Civil

A MEL FLUSH

R. COLLINS

JERRY VAN TONK CARBY  
D-12-23-1943

CLINT REYNOLDS

DOROTHEA REYNOLDS  
B-1912  
MAYBELLE E. REYNOLDS  
1890-1954  
MAXINE E. REYNOLDS  
D-1-5 to 10-1912  
DORIS E. REYNOLDS  
DAUGHTER C.E. D-10-28-1910  
ELIZABETH his wife  
B-1886  
D-1918  
C. CLINT REYNOLDS  
1878-1965

MYRTIE R. PHILLIPS  
B-7-5-1895  
D-8-7-1967  
PERBY A. PHILLIPS  
B-4-4-1894  
D-4-2-1970  
NORMA C. PHILLIPS  
B-4-28-1901  
D-7-28-1965  
W. LUYE PHILLIPS  
B-9-17-1901  
D-3-3-1961  
CODY W. REYNOLDS  
B-7-9-1898  
D-7-31-1976

STANFORD HILL

COLLINS

GRAVE

C.S. REYNOLDS

INFANT  
HARVEY REYNOLDS  
D-2-8-1950  
TITUS J. REYNOLDS  
1875-1948  
ELISH J. COON his wife  
B-3-8-1850  
D-1-20-1918  
CHARLES S. B. 10-7-1847  
REYNOLDS D-1-10-1929

MAUDE M. REYNOLDS  
B-2-8-1881  
D-11-6-1978  
DARLEY H. son of REYNOLDS  
B-7-30-1886  
D-1-28-1975  
ADALINE DICKERSON  
B-6-22-1856  
D-2-2-1907  
Gould J. REYNOLDS  
B-7-25-1850  
D-12-18-1914

GEO. S. REYNOLDS

JOHN VAN WINKLE

GRAVE

W.E. DICKERSON

EMMA DICKERSON  
B-7-4-1865  
D-2-2-1938  
W.E. DICKERSON  
B-1853  
D-1925  
W.E. DICKERSON  
B-11-30-1850  
D-2-12-1890

VAULT L.K  
JOSEPH KERSHAW VAULT  
VAULT

KERSHAW

JOSEPH KINSEY

GRAVE  
PEARL WESTLEY DICKERSON

WILLIAM GILMORE

PHEBE wife of Wm.  
B-1-12-1815 (HARRISON)  
D-4-21-1888 (COUNTY)  
WILLIAM GILMORE  
B-8-21-1813  
D-2-16-1888

HENRY C. KINSEY  
B- - - 1832  
D-6-1-1882 - Civil  
HENRY KINSEY

HENRY KINSEY

THOMAS CAIN

MARY MCCANN  
B-3-10-1831  
D-1-15-1904  
ROBERT MCCANN  
B- - - 1871

WALTER S. WASHINGTON  
D-6-28-1889 - son of GEO.  
192-23 yrs. 26 Ds. ELIZABETH  
WILLIAM E. KINSEY

HOLLIS B. SHELL  
B-9-11-1884  
D-4-1-1953  
HANNA his wife  
B-2-19-1846  
D-6-6-1935  
WILLIAM KINSEY  
B-8-31-1837  
D-3-13-1917

WILLIAM KINSEY

J.A. COX

GRAVE  
GRACE L. COX WIFE

**R. COLLINS**  
 JERRY VAN MORN GARY  
 D-12-23-1943

---

MARANDA COLLINS  
 B-8-23-1825  
 D-1-8-1904

ROBERT COLLINS  
 B-1-30-1897  
 D-78 Yrs. 5 DS.

PERMELIA JOHNSON  
 B-11-6-1853  
 D-4-6-1937

GEORGE W. JOHNSON  
 B-2-10-1844  
 D-9-11-1910

**COLLINS**

---

GEORGE COLLINS  
 B-7-5-1879 - AGE 3 Yr. 26 DS

GEORGE A. E. DUNLAP  
 B-1880 - D-1925

WALTER DUNLAP  
 B-1880 - D-1974

**JOHN VAN WINKLE**

---

GRAVE

---

GRAVE

---

MOTHER of Ed. SAM. + MAY  
 B-1-17-1853  
 D-7-3-1915

---

CAROLINE WIFE of  
 B-9-20-1829  
 D-6-12-1912

JOHN P. VAN WINKLE  
 B-1-24-1874  
 D-22 72 Yrs, 4 MS. 27 DS.

**JOSEPH KINSEY**

---

GRAVE

---

PEARL WESTLEY DICKERSON  
 B-10-6-1918  
 D- II

---

GRAVE

---

MARY C. KINSEY  
 B-1858 (MOTHER)  
 D-1916

CHARLEY H. KINSEY  
 B-3-13-1882  
 D-13 Yrs. 4 MS. 8 DS.

JOSEPH KINSEY  
 B-1-29-1833  
 D-12-25-1909

MARYANN WIFE  
 B-9-10-1877  
 D- 40 Yrs. 3 MS. 15 DS.

PINE TREE O

**THOMAS CAIN**

---

MARY MCCANN  
 B-3-10-1831  
 D-1-15-1904

ROBERT MCCANN  
 B-11-13-1824  
 D-1-15-1904

THOMAS J. CAIN  
 B-7-14-1825  
 D-5-10-1902

---

GRAVE

**J.A. COX**

---

GRACE L. COX W.R.C.  
 B. 1884  
 D-1962

ORA COX BALL W.R.C.  
 B. 1890  
 D. 1956

W. LESTER COX  
 B-1881  
 D-1953

JESSE V. COX  
 B-8-23-1878  
 D-7-8-1880

MAMIE SIMPSON COX  
 B-1855 W.R.C.  
 D-1949

JAMES DELMAR COX  
 B-1-2-1847  
 D-2-28-1908 **Civil**

**J. GILMORE**

---

ALICE G. GILMORE  
 71 Yrs. 8 MS. 15 DS.  
 D-3-7-1895

**A.J. COLLINS**

---

EFFIE M. DAU. of A.S. + S.L. COLLINS  
 B-12-6-1800  
 D-7-3-1891

MARILDA WILLIAMS  
 D-1899

A. J. COLLINS  
 B-1-17-1847  
 D-1-17-1933

CHARLES - SON of A.S. + S.L. COLLINS  
 B-1-11-26 DS.  
 D-8-28-1881

---

DAISY O. DAU. of A.S. + S.L. COLLINS  
 B-  
 D-8-6-1876

OSCAR L. COLLINS (SON of S.L.)  
 B-3-20-1877  
 D-20 Yrs. 1 Mo. 5 DS.

**WEST DICKERSON**

---

MARANDA CHAPMAN  
 B-10-14-1846 WIFE of  
 D-1-1-1905

W. M. DICKERSON  
 B-2-6-1834  
 D-  
 GRAVE

---

GRAVE

---

INFANT (OMA)

**J.W. KERSHAW**

---

JOHN W. KERSHAW  
 B-1838  
 D-1923

HANNA M. WIFE of Joseph Kershaw  
 B-12-10-1798  
 D-3-12-1839

ARON O. KERSHAW  
 B-7-7-1868  
 D-7-11-1870

MARY H. KERSHAW  
 B-5-19-1870  
 D-8-2-1873

PETE KERSHAW  
 B-3-27-1875  
 D-7-25-1876

SAMUEL A. KERSHAW  
 B-4-11-1887  
 D-2-8-1889

EMELINE BUCKLES (MOTHER)  
 B-11-25-1842  
 D-3-25-1894

**STANLEY DAVIS**

---

EMMA BELLE DAVIS  
 B-12-29-1862  
 D-11-25-1901

ERVIN S. DAVIS  
 B-12-30-1878  
 D-8-12-1886

JESSE  
 B-9-4-1857  
 D-10-20-1877

WILLIAM B. DAVIS  
 B-5-15-1881  
 D-3-18-1883

---

STANLEY DAVIS  
 B-1925  
 D-1997 **Civil**

DELICAH DAVIS  
 B-1835  
 D-1912

DAVID J. DAVIS  
 B-1-25-1862  
 D-AGE 21 Yrs. 2 MS.

**IRA COX**

---

JESSE COX  
 B-8-8-1871  
 AGE-

---

GEORGE HICKMAN  
 B-1884  
 D-1962

**J. GILMORE JOHNSON**

---

NATHANIEL GILMORE  
 B-11-22-1835  
 AGE 51 Yrs. 9 MS. 11 DS.

MARY A. GILMORE  
 D-3-21-1851  
 AGE-12 Yrs. 6 MS. 14 DS.

SARAH GILMORE  
 D-8-3-1852  
 AGE-13 Yrs. 3 MS. 20 DS.

**JOHN WEST**

---

JOHN H. WEST SON of  
 D-2-5-1872 S. + SARAH WEST  
 AGE-17 Yrs. 5 MS. 2 DS.

GRAVE + STONE

**Waddington**

---

STONE + GRAVE  
 NO DATES NO NAME

---

ELIZABETH BORN IN  
 B-12-11-1816 HOLDAM  
 D-3-10-1870 ENQ.

GEORGE Waddington  
 B-6-9-1818 Hudderfield

**KERSHAW**

---

Stone

---

Stone

---

Stone

**THOMAS TROVER**

---

MARY TROVER  
 D-5-30-1866  
 AGE-

THOMAS A. TROVER  
 D-2-23-1864  
 AGE **Civil**

IDA MAY  
 D-2-10-1861  
 AGE

**VANCE**

---

M. M. VANCE SON of  
 D-3-21-1867 M. M. VANCE  
 AGE-12 DS.

INFANT  
 B-3-21-1862  
 AGE-20 DS

30'  
30'  
30'



30

MATHWEL GILMORE  
B-11-22-1835  
AGE 51 Yrs. 9 Ms. 11 Ds.  
MARY A. GILMORE  
D-3-24-1851  
AGE-12 Yrs. 6 Ms. 14 Ds.  
SARAH GILMORE  
D-8-3-1852  
AGE-13 Yrs. 3 Ms. 10 Ds.  
MARY GILMORE  
B-12-2-1884  
D-AGE-76 Yrs. 3 Ms. 5 Ds.

JOHN H. WEST son of  
D-2-5-1872 S. SARAH WEST  
AGE-17 Yrs. 5 Ms. 2 Ds.  
GRAVE + STONE  
Sophia A. L. WEST  
MAHALA A. DAUGHTER S. + M.A.  
D-2-16-1882 Sterling  
AGE-8 Ms. 12 Ds.  
EVA JANE DAUGHTER S. + M.A.  
D-2-25-1885 Sterling  
AGE-9 Ms  
Sophia wife of Wm. A. West  
D-9-8-1882 West  
AGE-65 Yrs. 6 Ms. 3 Ds.

ELIZABETH BORN IN  
B-12-11-1816 Holdam  
D-3-10-1870 EN9.  
GEORGE Waddington  
B-6-9-1818 Hudderfield  
D-6-19-1876 EN9.  
John - PAYNE  
ESTHER, MARY, MAX,  
MONTGOMERY 1884-1903

AGE-  
THOMAS A. TROVER  
D-2-23-1864  
AGE CIVIL  
IDA MAY  
D-2-10-1861  
AGE

AGE-12 Ds. VANCE  
INFANT  
B-3-21-1861  
AGE-20 Ds  
VANCE  
DATES

22

SARAH GILMORE  
D-8-3-1852  
AGE-13 Yrs. 1 Ms. 20 Ds.  
ANDREW H. GILMORE  
D-10-17-1870  
AGE-3 Yrs.  
JOSEPH F. GILMORE  
D-6-9-1881  
AGE-1 Yrs. 6 Ms.  
JERRY C. GILMORE  
D-11-4-1884  
AGE-10 Yrs. 7 Ds.  
REBECCA GILMORE  
D-2-13-1865  
AGE-8 Yrs. 8 Ms. 10 Ds.

INFANT SON  
B-3-19-1842  
D-2-11-1846  
IRA E. COLLINS  
D-5-21-1842  
AGE 1 Yr. 6 Ms. 2 Ds.  
GEORGE E. COLLINS  
D-8-16-1863  
AGE  
STONE  
ROBT. COLLINS

ABRAHAM BUCKLES  
B-6-26-1800  
D-5-17-1875  
DOLLY BUCKLES wife of  
B.  
D-12-19-1876  
ANDREW J. BUCKLES  
D-9-5-1870  
AGE-40 Yrs. 5 Ms. 20 Ds.  
MARVE W. + M. A. CLINE  
D-9-20-1856  
AGE-11 Yrs. 4 Ms. 20 Ds.  
ADAM BUCKLES

ABRAHAM BUCKLES  
D-12-7-1848 SON OF  
AGE 8 MS. N.M. + M.E. BUCKLES  
ANN DAUGHTER  
D-2-25-1846 N.M. + M.E.  
AGE 13 MS. BUCKLES  
MARY wife of ARRON WILLIAMS  
D-1-26-1885  
AGE-67-4 MS. 20 Ds.  
A. WILLIAMS

JOHN P. WILLIAMS  
D-5-27-1856  
AGE-36 Yrs 11 Ds.  
JANE C. wife of  
D-7-26-1853 Blackford  
AGE 34 Yrs. 7 Ms. 20 Ds.  
ALFRED V. SON OF  
B-11-6-1852 J.P. + R. CREAGER  
AGE 9 MS. 1 Ds.  
J. H. SCOTT

ABRAM SCOTT  
D-12-4-1864  
AGE-4 Yrs. 19 Ds  
ALFRED V. SON OF  
B-11-6-1852 J.P. + R. CREAGER  
AGE 9 MS. 1 Ds.  
J. H. SCOTT

3

J. GILMORE  
BETHEL  
BETHEL  
D-8-21-1857 CHILDREN  
AGE-4 Yrs.

ROBT. COLLINS  
MARANDA B. SILVERS  
B-1878  
D-1954  
EARNEST V. SILVERS  
B-1874  
D-1950  
AMERICUS COLLINS  
D-3-15-1883  
AGE-3 Yrs. 9 Ms. 19 Ds.  
INFANT COLLINS  
D-3-1-1875  
MYRTLE COLLINS  
B-1-7-1872  
AGE-3 Wks. 3 Ds.

WOOD  
MARY  
B-1-18-1830 wife of JOHN WOOD  
D-12-12-1872

VANDEVENTER  
INFANT JOHN W. ROLAN  
D-7-3-1884  
AGE-3 Yrs. 7 Ms. 19 Ds.  
HARRIET DAUGHTER  
B-12-17-1833 VANDEVENTER  
AGE-15 Yrs. 3 Ms. 11 Ds.

J. W. KARR  
ARRON SON OF J. W. + T. KARR  
D-6-15-1871  
NANCY J. KARR  
B-6-18-1840  
D-5-17-1908  
TABITHA wife of JOHN KARR  
B. NO DATES  
JOHN W. KARR  
B-4-21-1823  
D-1-31-1903  
SARAH  
B-1860  
D-1861  
MCDEAN  
B-1863  
D-1914

CRUMBAUGH  
JOHN W. WEST  
D-12-27-1861  
AGE-25 Yrs. 2 Ms. 15 Ds.  
Wife CRUMBAUGH  
D-7-13-1880  
AGE-61 Yrs. 8 Ms. 10 Ds.  
MARY ANN  
D-11-8-1866

30

30

29

28

4

3

4

3

4

1

2

1

2

1

BETHEL  
D-8-21-1857 CHILDREN  
AGE-4 YRS.  
ELIZA J. D. BETHEL  
D-8-22-1882  
INFANTS CHILDREN  
□ □ □

D-1956  
EARNEST V. SILVERS  
B-1874  
D-1950  
AMERICUS COLLINS  
D-3-15-1883  
AGE-3 YRS. 9 MS. 15 DS.  
INFANT COLLINS  
D-3-1-1875  
MYRTLE COLLINS  
B-1-7-1872  
AGE-3 WKS. 3 DS.

MARY  
B-1-18-1830 WIFE OF  
D-12-12-1872 JOHN WOOD

INFANT JOHN W.  
D-7-3-1884 ROLAN  
AGE-3 YRS. 7 MS. 19 DS.  
HARRIET DAU. OF  
B-12-17-1833 VANDEVENTER  
AGE-15 YRS. 3 MS. 4 DS.  
ROLAN VANDEVENTER  
D-8-27-1851  
AGE-12 MS. 7 DS.

NANCY J. KARR  
B-6-18-1840  
D-5-17-1908  
TABITHA WIFE OF JOHN KARR  
B- NO DATES  
D-  
JOHN W. KARR  
B-4-21-1823  
D-1-31-1903  
SARAH  
B-1860  
D-1861  
MC KEAN  
B-1863  
D-1864  
MONROE  
B-1869  
D-1870  
INFANT SON  
B-1882 - 1982

JOHN W. WEST  
D-12-27-1861  
AGE-25 YRS. 4 MS. 15 DS.  
WIFE CRUM BAUGH  
D-7-13-1880  
AGE-6 YRS. 8 MS. 10 DS.  
MARY ANN  
D-11-8-1866  
AGE-14 YRS. 11 MS. 21 DS.  
MARTHA CRUM BAUGH  
D-5-17-1849  
AGE-5 YRS. 3 MS. 3 DS.

CLARA  
ELIZABETH HARPER - WIFE OF  
D-7-29-1855 N. HARPER  
MARY ELLEN HARPER  
D-11-13-1862 DAU. OF  
AGE-5 MS. 9 DS.  
THOMAS C. WOOD SON OF  
B-2-19-1861 A.M.C.  
AGE-7 MS. 13 DS. WOOD  
ANNA WIFE OF JOSHUA WOOD  
D-28-1860  
GARRIE DAU. OF J. R. MITCHELL  
B-10-22-1875  
AGE-2 YRS. 10 MS. 7 DS.  
HARRY SON OF E. N. MITCHELL  
D-11-8-1870  
AGE-7 YRS. 19 DS.

JOHN SUTTON  
B-3-5-1881  
D-1-17-1895  
ELLEN HIS WIFE  
B-6-22-1833  
D-8-7-1871  
INFANT J. T. + E. SUTTON  
D-2-8-1870 CHILD.  
LYDA HANSON WIFE  
D-8-2-1872  
AGE-73 YRS. 10 MS. 13 DS.

Stone name  
washed off  
INFANT  
STONE WASHED OFF  
JAMES EDWARD SON OF  
B-4-16-1878 S. + M. A.  
D-11-1-1899  
MARTHA A. WEST  
B-12-1-1832 WIFE  
D-12-1-1905  
SAMUEL STERLING  
B-7-27-1824  
D-2-17-1905

WILLIAM W. PUGH  
D-3-25-1855  
AGE-29 YRS.  
INFANT - DANIEL + ELIZABETH  
ABIGAIL ADAMS MCINTURE  
STONE  
ELIZABETH J. MELCHER  
B-9-20-1830  
D-3-1-1905  
DANIEL ROLAN  
B-1-6-1827  
D-8-1896

MARY S. BUCKLES  
B-8-12-1934  
JAMES A. STUART  
D-3-21-1857  
AGE-26-9 MS. 25 DS.  
Body  
AMAND M. STUART  
D-2-8-1856  
AGE-28 MS. 22 DS.  
INFANT  
D-1-28-1855  
ANDERSON

INFANT  
SAMUEL ELIZABETH SMITH  
B-2-14-1835  
D-1-29-1855  
MARY N. ESKEW  
D-4-20-1879  
AGE-22 YRS. 2 MS. 22 DS.

C.P. DICKERSON  
CALEB D. DICKERSON  
B-26-1827-1-23-1908  
TOBITHA DICKERSON  
4-23-1834-11-17-1908  
Body

B.B. RUTLEDGE  
LULA 10-29-1880  
3 YRS 7 MS 20 DS.  
Body?  
Body?  
Body  
Body

J.R. CRAIG  
J.R. CRAIG  
9-10-1845-7-6-1906  
TOBITHA CRAIG  
3-31-1849-7-20-1880  
EDNA P. CRAIG  
1917-1936  
AGNES CRAIG  
9-8-1906-4-1921  
MARQUERITE CRAIG  
1-31-1920-5-13-1921

CONAWAY  
ANNA CONAWAY  
3-27-1877-1M. 27 DS.  
Body?  
Body?  
Body?

D. ROLAND  
ALFRED HINES  
3-17-1878 27 DS.  
SON OF GAT S. E. HINES  
Body?  
Body?  
IVA L. CRAIG  
1887-1973  
ROBERT H. CRAIG  
1874-3-5-1949

GOOKER  
GEO. SON OF L. N. H. LYNN  
Gooker 11-23-1879 3M.  
MELINDA S. HILDREN  
8-26-1846-6-20-1920  
Body?  
Body?

30'  
30'  
30'  
4'  
25'  
4'

31

32

33

.8 .8 .8 .8 .8 .8 .8 .8 .8 .8

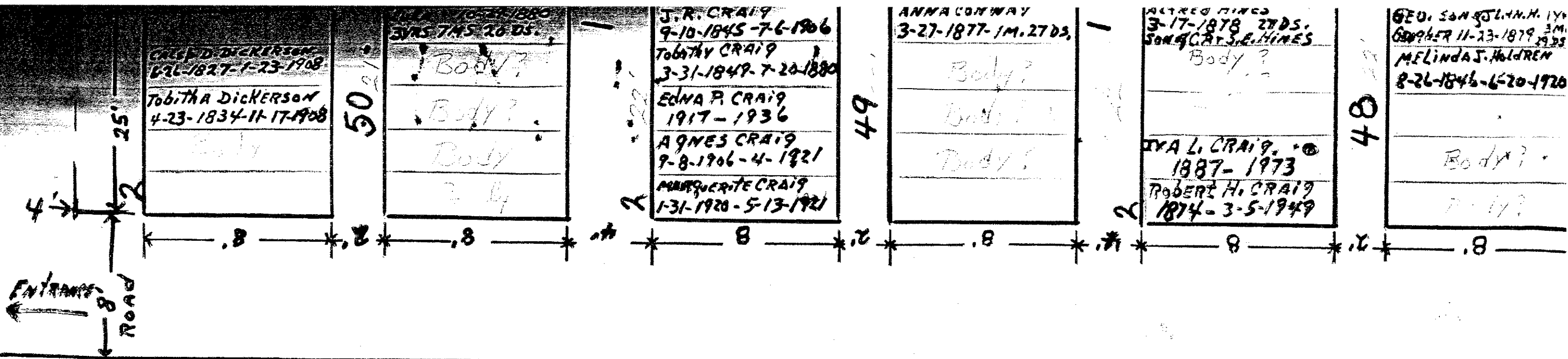

WEST SIDE + EAST

WEST SIDE

WEST

EAST OF LANE

WILLIAM GILMORE

1 2  
PHEBE WIFE OF WM.  
B-2-12-1815 (HARRISON)  
D-4-21-1888 (COUNTY)  
WILLIAM GILMORE  
B-8-21-1813  
D-2-16-1888

John VAN HOLSTEIN

1 2  
CLERISSA VAN HOLSTEIN  
B-7-26-1864  
D-8-18-1902

ADAM SIGLER

FRED T. RAZOR

Body

FREDERICK RAZOR  
B-1-3-1827-D-

FRED RAZOR

8  
WALTER S. WASHINGTON  
D-6-28-1889 - SON OF GEO.  
AGE 23 YRS. 26 DS. ELIZABETH  
WILLIAM E. KINSEY

HOLLIS B. SHELL  
B-9-11-1884  
D-4-1-1953  
HANNA his wife  
B-2-19-1846  
D-6-6-1935  
WILLIAM KINSEY  
B-8-31-1837  
D-3-13-1917

4 3  
HENRY C. KINSEY  
B- - - 1832  
D-6-1-1882 - CIVIL  
HENRY KINSEY

WILLIAM KINSEY

1 2  
INFANT SON  
B-2-23-  
D- - - 1876  
CHARLES RAZOR  
B-1853-1939  
D- - -  
MARGARET RAZOR  
B-1863-1945  
D- - -

4 3  
CHARLES RAZOR

1 2  
REBECCA J. SIGLER  
B-12-3-1858  
D-5-23-1932  
FRANK SIGLER  
B-1-18-1887  
D-20 YRS. 2 MS. 7 DS.  
ANNIE M. SIGLER  
B-6-9-1876  
D-13 YRS. 5 MS. 13 DS.  
HARRIETT WIFE OF JOHN  
B- - - 1803  
D-26 YRS. 13 DS.  
JOHN SIGLER  
B-10-29-1852  
D-2-25-1935

4 3  
JOHN SIGLER

OLAE DAY  
B-1890-1966

ELMER L. DAY  
B-1892-D-1945

HENRY SIGLER  
B-10-22-1852-  
D-8-28-1895

MARY WIFE OF C.W. SIGLER  
B-6-4-1828-D-4-20-1895

GEO. W. SIGLER  
B-7-27-1820  
D-4-10-1902

JAMES A. SIGLER  
B-2-7-1863  
D-7-19-1904

4 3  
GEO. W. SIGLER

6  
DAVID J. GAULTNEY II  
B-10-16-1925-D-2-3-45!  
RALPH M. GAULTNEY  
B-8-23-1910  
D-12-24-1941 II  
NELLIE A.  
GAULTNEY  
B-1889-D-1948  
WILLIAM B-1889  
M.  
GAULTNEY D-1968  
LOUISA AGE 22 YRS  
C. 20 DS.  
KIMLER

4  
LEE KIMLER

THOMAS CAIN

1 2  
MARY MCCANN  
B-3-10-1831  
D- - - 1896

J. A. COX

ROBT. MCNEIL

1 2  
GRAVE

JACK THOMAS

1 2  
W. H. MICKELS

C. D. WATERS

1  
SON NAME  
SUTHERSAL INFANT  
B-12-3-1945-D-12-3-1945

HENRY KINSEY

WILLIAM KINSEY

CHARLES KAZOR

JOHN SIGLER

GEO. W. SIGLER

LEE KIMLER

THOMAS CAIN

MARY MCCANN  
B-3-10-1831  
D-1-15-1904

ROBERT MCCANN  
B-11-13-1824  
D-1-15-1904

THOMAS J. CAIN  
B-7-14-1825  
D-5-10-1902

GRAVE

J.A. COX

GRACE L. COX W.R.C.  
B. 1884  
D-1962

NORA COX BALL W.R.C.  
B. 1890  
D. 1956

W. LESTER COX  
B-1881  
D-1953

JESSE V. COX  
B-8-23-1878  
D-7-8-1880

MAMIE SIMPSON COX  
B-1855 W.R.C.  
D-1949

JAMES DELMAR COX  
B-1-2-1847  
D-2-28-1908 **civil**

ROBT. MCNEIL

GRAVE

GRAVE

A. D. RAQLE  
B-8-15-1869  
D-2-21-1899

SAMUEL MCNEIL  
B-1851  
D-1924

ROBERT C. MCNEIL  
B-11-25-1846  
D-8-15-1916

GRAVE

JACK THOMAS

GRAVE

GRAVE

GRAVE

GRAVE

GRAVE

GRAVE

GRAVE

GRAVE

GRAVE

W.H. MICKELS

FAY MARIE MITCHELL  
B-1925  
D-2-9-1957

C. D. WATERS

UN NAMED INFANT  
SOTHEBIAL INFANT  
B-12-3-1945-D-12-3-1945

CALLI B-1878  
WATERS D-1973

GRACE 2 YRS old  
WATERS ~~DAUGHTER~~ ALICE

ADAH B-1880  
WATERS D-1947

ALICE S. B-1826  
WATERS D-1957

S. LAS B-1893-12-9  
WATERS D-1937-12-13

MOVED TO OAK GROVE CEM.

EMMA BELLE DAVIS  
B-12-29-1862  
D-11-25-1901

ERVIN S. DAVIS  
B-12-30-1879  
D-8-12-1886

JESSE  
B-9-4-1857  
D-10-20-1877

WILLIAM B. DAVIS  
B-5-15-1881  
D-3-18-1883

STANLEY DAVIS  
B-1825  
D-1997 **civil**

DELICAH DAVIS  
B-1835  
D-1912

DAVID J. DAVIS  
B-1-25-1862  
D-AGE 21 YRS. 2 MS.

STANLEY DAVIS

JESSE COX  
D-8-8-1871  
AGE-

GEORGE HICKMAN  
B-1884  
D-1962

IRA COX

WILLIAM M. COX  
B-6-7-1837  
D-1878 AGE 41 YRS 21 DYS

HENRIETTA M. COX  
B-6-22-1858  
D-4-7-1881 AGE 23 YRS 10 MS

LOUIS A. WIFE OF  
B. 4-26-1809  
D. 3-6-1892

JESSE R. COX  
B-12-10-1808  
D-11-16-1886 **civil**

JESS R. COX

LYDIA J. BRADLEY  
B-1868  
D-1921

ELLIS F. BRADLEY  
B-1865  
D-1946

NORA BRADLEY  
B-1897  
D-1967

HAL BRADLEY  
B-1894  
D-1953 **II**

E. F. BRADLEY

MARTHA B-1-6-1864  
FRY D-1-14-1886

INFANT AGE-2 YRS

FRY D-4-11-1873

REBECCA B-7-7-1829  
FRY D-5-15-1897

JOHN B. B-9-4-1824  
FRY D-1-14-1903

JOHN FRY

CHAS. SIGLER  
B-1883  
D-6-9-1956

PETER B-10-21-1844  
SIGLER D-11-9-1902

SARAH B-1855  
SIGLER D-1876

ADAM B-1847  
SIGLER D-1927

ADAM SIGLER

THOMAS TROVER

MARY TROVER  
D-5-30-1866  
AGE-

THOMAS A. TROVER  
D-2-23-1864  
AGE **civil**

IDA MAY  
D-2-10-1861  
AGE

VANCE

M.M. VANCE son of M.M. VANCE  
D-3-21-1867  
AGE-12 DS

INFANT  
B-3-21-1861  
AGE-20 DS

J. R. KARR

FRANKLIN son of J. R. KARR  
B-1-16-1871  
AGE 20 DS

WILLIAMS

GRAVE

GRAVE

GRAVE

GEO. W. RUNYON

MARY F. NICHOLAS  
B-10-13-1875  
D-1954

WILLIAM M. NICHOLAS  
B-1871  
D-1939

GRAVE

IDA M. RUNYON  
D-1918

W.M. DAVIS

DAUGHTER OF DAVIS  
D-11-28-1860  
AGE-1 DAY old.

JOHN W. DAVIS son of  
B-  
D-8-18-1861

WALTER F. DAVIS  
B-  
D-2-23-1873

DEBORAH DAVIS  
B-11-14-1883



THOMAS A. TROVER  
D-2-23-1864  
AGE CIVIL  
IDA MAY  
D-2-10-1861  
AGE

INFANT  
B-3-21-1861  
AGE-20 DS  
M. W. WILSON  
DATES

FRANKLIN SON OF M. T. HARPER  
B-1-16-1871  
AGE 20 DS.  
ELLEN KARR  
B-6-21-1861  
D-12-19-1865  
PERMELIA WILLIAMS KARR  
B-4-7-1825  
D-2-5-1917  
JESSE KARR  
B-3-30-1825  
D-7-25-1912

2  
3  
4  
5  
6  
7 GRAVE + STONE  
8

B. 1871  
D. 1939  
GRAVE  
IDA M RUNYON  
B- 1868  
D- 1910  
L. E. RUNYON  
B- 1837  
D- 1908  
GEORGE W. RUNYON  
B AGE-76 YRS. 9 MS. 20 DS  
D-4-25-1894

WALTER F. DAVIS  
B-  
D-2-23-1873  
DEBORAH DAVIS  
B-11-14-1883  
D-12-14-1903  
WILLIAM A. DAVIS  
B-8-19-1818  
D-2-15-1887  
T. J. REED Co. A. CIVIL  
DAUGHTER  
J. L. + R. E. REED  
D-7-8-1861  
43 YRS. Oct. 16-1889

Road

JOHN P. WILLIAMS  
D-5-27-1856  
AGE-36 YRS 11 DS.  
JANE C. wife of  
D-7-26-1853 Blackford  
AGE-34 YRS. 7 MS. 20 DS.  
MARY wife of ARROW  
D-1-26-1885 WILLIAMS  
AGE-67-4 MS. 7 DS.

ABRAM SCOTT  
D-12-4-1864  
AGE-4 YRS. 19 DS  
ALFRED V. son of  
B-11-6-1852 J.P. + R.  
AGE 9 MS. 18 DS CREAGER

DICY wife of C. COVEY  
B-7-29-1818 AGE-77  
D-8-4-1895 5 DS.  
EORNELIUS COVEY  
D-1-18-1892  
AGE-77 YRS. 10 MS. 22 DS.  
WILLIAM COVEY  
B-9-23-1862  
AGE-5 YRS. 10 MS.  
CATHERINE wife of F.  
B-10-19-1863 Johnson  
AGE-24 YRS-11 MS. 25 DS.  
SARAH E. COVEY  
D-10-10-51  
AGE-5 YRS. 6 MS. 3 DS.  
NATHAN COVEY  
D-12-1-1851  
AGE-3 YRS. 6 MS. 2 DS.

WILLIAM JOHN son of J. JOHNSON  
B-2-13-1866  
AGE 19. 1 MO. 29 DS.  
JURIAH SON of WM. JOHNSON  
RACHEL DUGH  
B-3-26-1818  
AGE-7 YRS. 6 MS. 27 DS.  
ROSABELLE RUNYON  
D-5-17-1862  
AGE 1 Yr. 4 MS. 11 DS.

MELVIN JOHNSON  
D-1-11-1860  
AGE-7 DS.  
WILLIAM J. JOHNSON  
D-9-1-1839  
AGE-2 YRS.  
JAMES R. JOHNSON  
MARY wife of J. R. JOHNSON  
B-3-10-1813  
D-9-10-1900  
CLEMON BARNHOUSE  
D-10-29-1894

1  
2  
3  
4  
5  
6 GRAVE  
7 Body  
8

43

28

27

26

121

A. WILLIAMS

J. H. SCOTT

COVEY

JOHNSON

JAMES JOHNSON

HENDRICH

J. W. KARR  
ARROW SON OF J. W. + T. KARR  
D-6-15-1871  
NANCY J. KARR  
B-6-18-1840  
D-5-17-1908  
Tabitha wife of JOHN KARR  
B- NO DATES  
D-  
John W. KARR  
B-4-21-1823  
D-1-31-1903  
SARAH  
B-1860  
D-1861  
Mc KEAN  
B-1863  
D-1864  
MONROE

JOHN W. WEST  
D-12-27-1861  
AGE-25 YRS. 2 MS. 15 DS.  
Wife CRUM BAUGH  
D-7-13-1880  
AGE-61 YRS. 8 MS 10 DS.  
MARY ANN  
D-11-8-1866  
AGE-14 YRS. 11 MS. 21 DS.  
MARTHA CRUMBAUGH

JOHN H. ESKEW  
Bro. of R.C.  
PARAN C. son of P.G. + B.  
D-1-8-1861  
AGE-6 MS. 22 DS. ESKEW  
Body + Stone  
SARAH wife of P.G. ESKEW  
B-6-10-1816  
D-6-11-1876  
PARAN C. ESKEW  
B-12-3-1815  
D-10-12-1898  
WILLIAM A. ESKEW

BEARD

MCCANN  
RACHEL B-8-1796  
COCHRAN D-10-1858  
MCCANN  
RACHEL B-8-1796  
COCHRAN D-10-1858  
MCCANN  
B-1796 D-10-1858

Wm. McCANN  
RACHEL MCCANN SEALL  
B-9-23-1855  
D-4-5-1894  
LIZZI SARAH MCCANN  
B-3-15-1862  
D-5-4-1870  
JOHN J. MCCANN  
B-1-2-1871  
D-5-25-1871  
MARY GILMORE MCCANN  
B-10-24-1836  
D-3-23-1904  
Wm. L. McCann  
B-5-19-1829  
D-7-12-1908  
LARKINS. McCann  
B-1876 1959

12

12

12

1

ARROW SON OF T.W. & T. KARR  
D-6-15-1871

NANCY S. KARR  
B-6-18-1840  
D-5-17-1908

TABITHA wife of JOHN KARR  
B- No DATES  
D-

JOHN W. KARR  
B-4-21-1823  
D-1-31-1903

SARAH  
B-1860  
D-1861

MC DEAN  
B-1863  
D-1864

MONROE  
B-1869  
D-1870

INFANT SON  
B-1882 - 1982

JOHN W. WEST  
D-12-27-1861

AGE-25 YRS. 2 MS. 15 DS.

Wife CRUMBAUGH  
D-7-13-1880

AGE-6 YRS. 8 MS. 10 DS.

MARY ANN  
D-11-8-1866

AGE-14 YRS. 11 MS. 21 DS.

MARTHA CRUMBAUGH  
D-5-17-1849

AGE-5 YRS. 3 MS. 3 DS.

JOHN H. ESKEW  
Bro. of R.C.

PARAN S. son of P.G. & S.  
D-1-8-1861 ESKEW

AGE-6 MS. 22 DS.

Body - Stone

SARAH wife of P.G. ESKEW  
B-6-20-1816  
D-6-11-1876

PARAN C. ESKEW  
B-12-3-1815  
D-10-12-1898

WILLIAM A. ESKEW  
No DATES

MARY N. ESKEW  
D-4-20-1829

AGE-22 YRS. 2 MS. 22 DS

Empty box

RACHEL B-8-1746  
COCHRAN D-10-1858  
MCCANN

RACHEL B-8-1796  
COCHRAN  
MCCANN D-10-1858

51796 D-10-1858

B-9-23-1853  
D-4-5-1894

LIZZIE SARAH MCCANN  
B-3-15-1862  
D-5-4-1870

JOHN J. MCCANN  
B-1-2-1871  
D-8-25-1891

MARY ELIZABETH MCCANN  
B-10-24-1836  
D-3-23-1904

Wm. L. McCann  
B-5-19-1829  
D-7-12-1908

LARKIN S. McCann  
B-1876  
1959

MARY S. BUCKLES  
B-8-12-1934

JAMES A. STUART  
D-3-21-1857

AGE-26-9 MS. 25 DS

Body

AMAND M. STUART  
D-2-8-1856

AGE-28 MS. 22 DS

INFANT  
D-1-28-1855

ANDERSON

civil

INFANT

SAMUEL ELIZABETH  
B-2-14-1835  
D-1-29-1855

MARY N. ESKEW  
D-4-20-1879

AGE-22 YRS. 2 MS. 22 DS

M

WALTER ORVILL GOWLS  
D-1890  
D-1963

JAMES HENRY PEAVLER  
B-1827-D-3-5-1959

CHARLES E. PEAVLER  
B-1879  
D-1943

CLARA L. PEAVLER  
B-1883  
D-1952

GEORGE W. DEEN  
D-1-28-1871

AGE-33 YRS. 7 MS. 14 DS.

John W. DEEN  
B-12-18-1835  
D-9-18-1911

civil

CATHERINE wife of W.A. MCFARLAND  
B-3-1-1875

WILLIAM MCFARLAND  
D-8-15-1886

AGE-47 YRS. 6 MS. 4 DS

J. P. T. BEARD  
Co. 1, 37th Inf. civil

MARTHA J. wife of JACOB WALTERS  
B-4-8-1832  
D-8-13-1904

MARTHA J. wife of WILLIAM BEARD  
B-10-28-1793  
D-7-10-1881

D. ROLAND

ALFRED HINES  
B-17-1878 27 DS.  
SON OF C. & E. HINES

Body?

IVA L. CRAIG  
1887-1973

ROBERT H. CRAIG  
1874-3-5-1949

GOSHER

GEO. SON OF L.M.H. LYNN  
D-11-23-1879 31 DS.

MELINDA S. HOLDREN  
B-26-1846-6-20-1920

Body?

Body?

E. BROCK

INFANT SON OF BROCK  
1-10-1891-2 MS. 25 DS

HARRY BLEAVENS  
1878-1954-3-30

LAURA M. BLEAVENS  
1883-10-20-1977

JOHN EVERETT BLEAVENS  
11-28-1906-6-28-1975

A. NEWBY

Body?

ROSE NEWBY  
1890-1918

JENNIE NEWBY  
1879-1908

SAMUEL TUDOR

SAMUAL J. TUDOR  
1878-1935

MAUDE TUDOR  
1881-1958

Body?

TUDOR

JAMES TUDOR  
1877-1935

JAMES TUDOR  
1907

GROVER C. TUDOR  
1884-1907 I

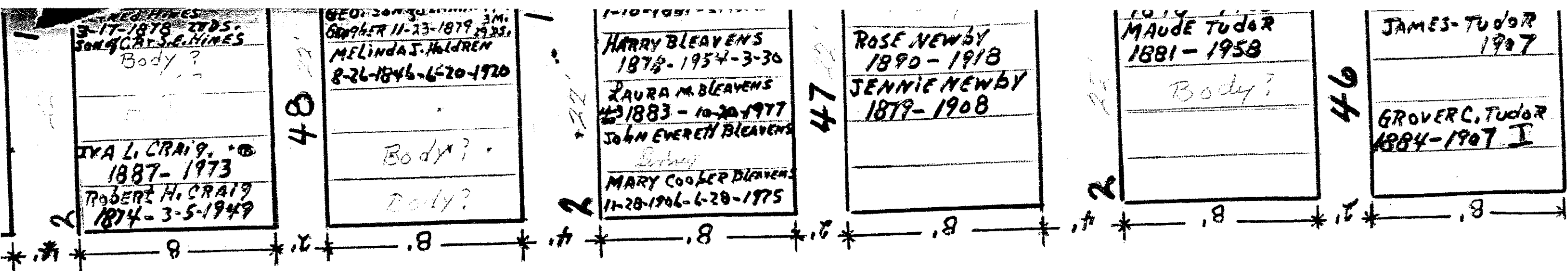

1 ( ) S + 11 1 2 ( ) X 2 ( )  
 2 ( ) X 2 ( ) 2 ( ) X 1 ( )  
 2 ( ) X 1 ( )

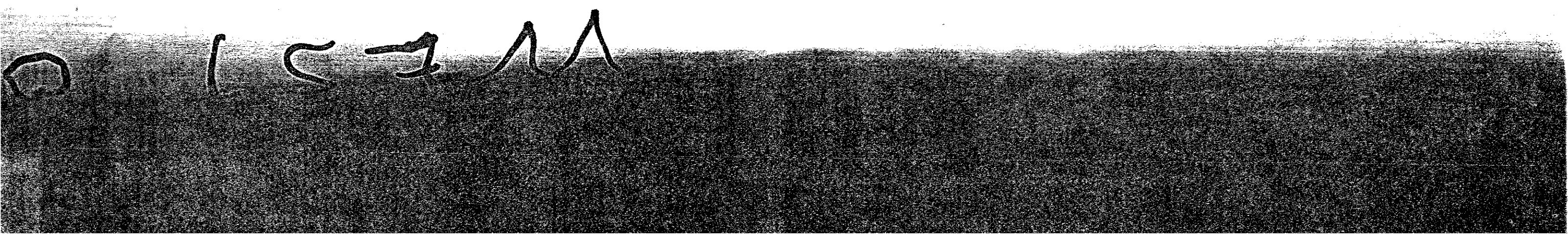

NORTH

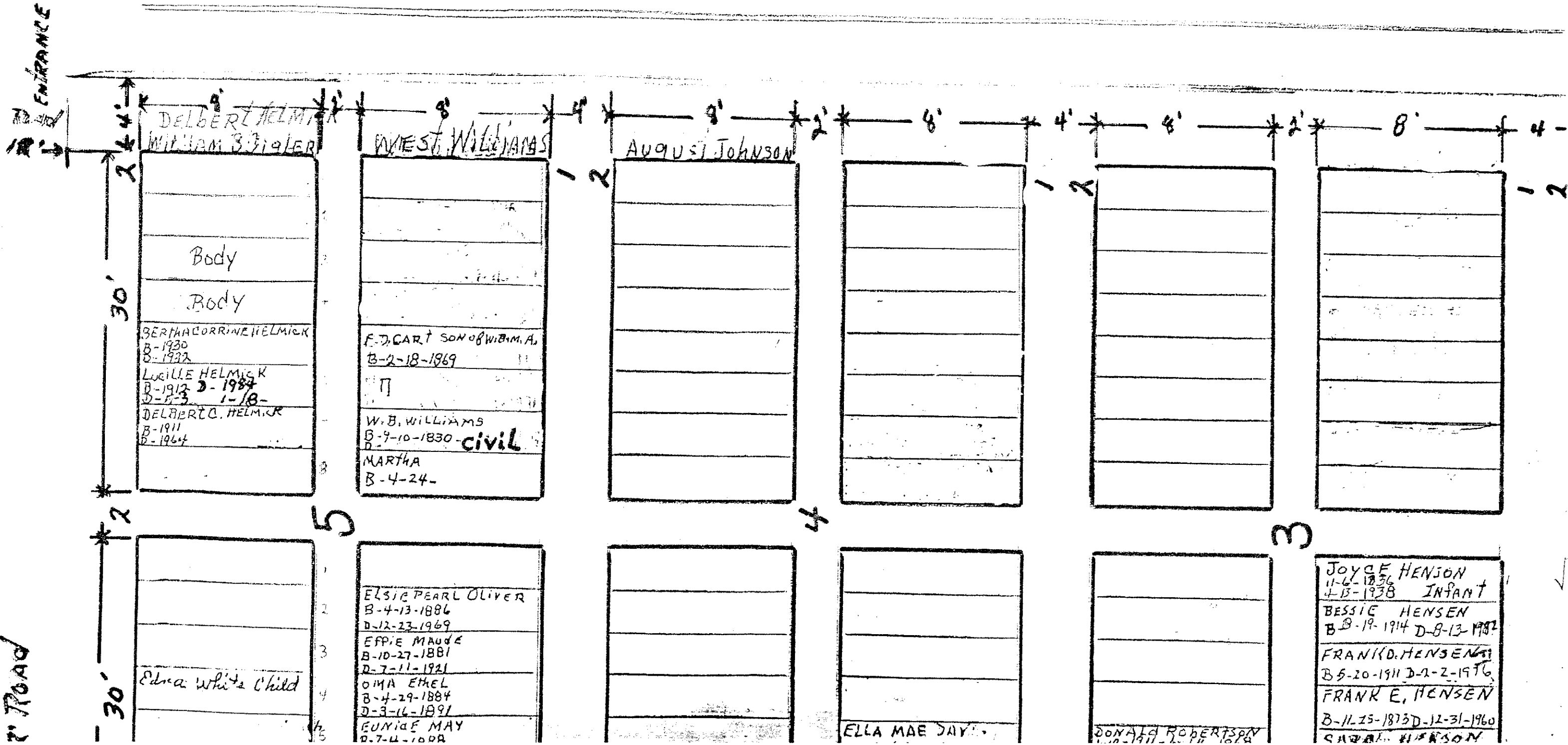

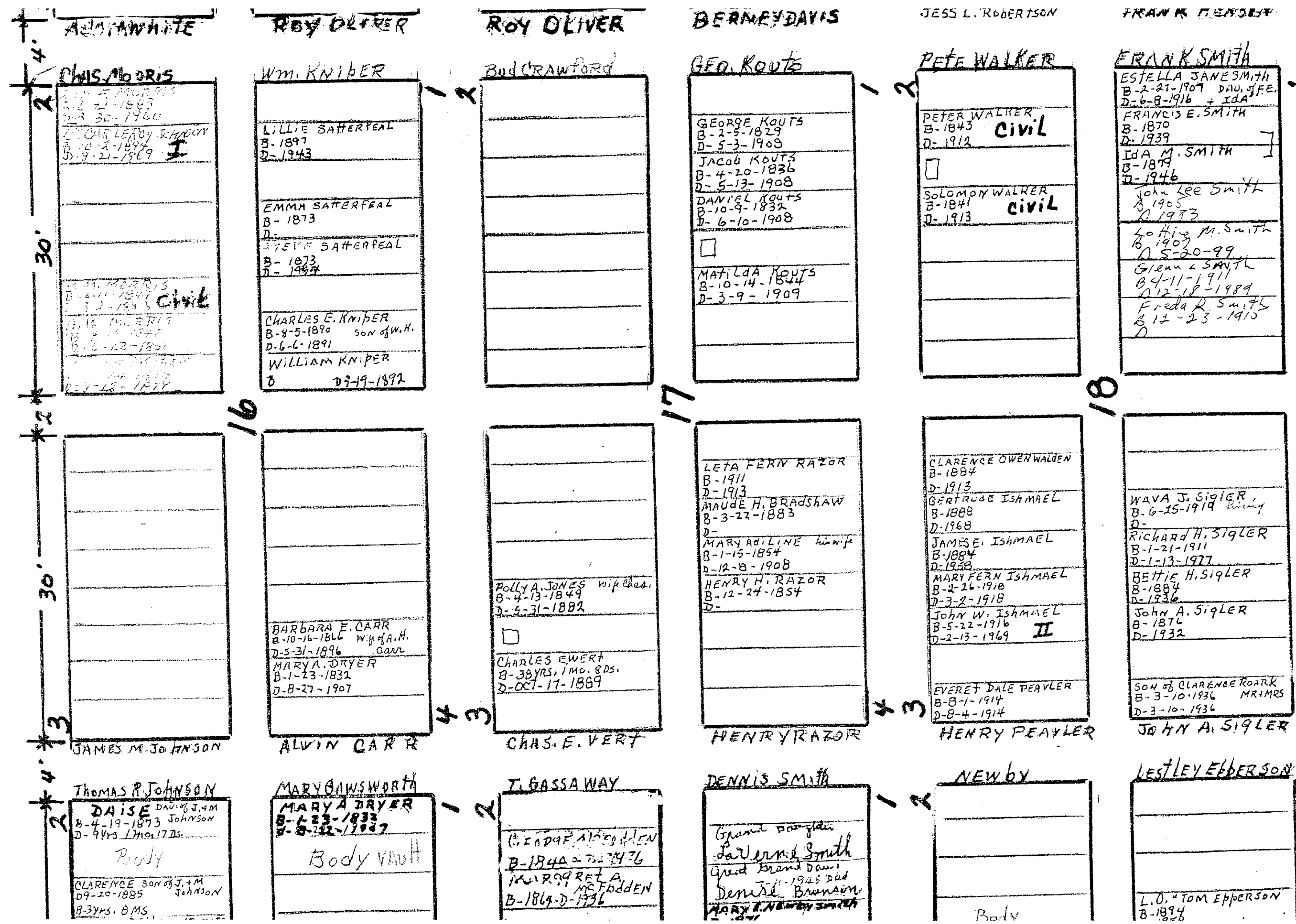

ALMA WHITE

ROY OLIVER

ROY OLIVER

BERNIE DAVIS

JESS L. ROBERTSON

FRANK MEMORY

CHAS. MORRIS

Wm. KNIPER

Bud CRAWFORD

GEO. KOUTS

PETE WALKER

FRANK SMITH

CHAS. MORRIS  
B-2-2-1893  
D-3-30-1960  
CHARLES ROY JOHNSON  
B-10-2-1894  
D-9-21-1969  
CHAS. MORRIS  
B-4-11-1897  
D-10-1893  
CHAS. MORRIS  
B-4-11-1897  
D-6-22-1897  
CHAS. MORRIS  
B-4-11-1897  
D-1-12-1977

LILLIE SATTERFEAL  
B-1897  
D-1943  
EMMA SATTERFEAL  
B-1873  
D-  
JEFF SATTERFEAL  
B-1873  
D-1957  
CHARLES E. KNIPER  
B-8-5-1890 son of W.H.  
D-6-6-1891  
WILLIAM KNIPER  
B 09-19-1892

Bud CRAWFORD

GEORGE KOUTS  
B-2-5-1829  
D-5-3-1908  
JACOB KOUTS  
B-4-20-1836  
D-5-13-1908  
DAVID KOUTS  
B-10-9-1832  
D-6-10-1908  
MATELDA KOUTS  
B-10-14-1844  
D-3-9-1909

PETER WALKER  
B-1843  
D-1912  
CIVIL  
SOLOMON WALKER  
B-1841  
D-1913  
CIVIL

ESTELLA JAMES SMITH  
B-2-21-1907 DAU. OF F.E.  
D-6-8-1916 + IDA  
FRANCIS E. SMITH  
B-1870  
D-1939  
IDA M. SMITH  
B-1879  
D-1946  
John Lee Smith  
B-1905  
D-1973  
Lottie M. Smith  
B-1907  
D-5-20-99  
Glenn L. Smith  
B-4-11-1911  
D-12-18-1989  
Freda R. Smith  
B-12-23-1915  
D

JAMES M. JOHNSON

BARBARA E. CARR  
B-10-16-1866 Wif of A.H.  
D-5-31-1896 Carr  
MARY A. DRYER  
B-1-23-1832  
D-8-27-1907

Polly A. JONES wif Chas.  
B-4-13-1849  
D-5-31-1882  
CHARLES EWERT  
B-38YRS, 1 MO. 8 DS.  
D-OCT-17-1889

LETA FERN RAZOR  
B-1911  
D-1913  
MAUDE H. BRADSHAW  
B-3-22-1883  
D-  
MARY ADLINE wif wife  
B-1-15-1854  
D-12-8-1908  
HENRY H. RAZOR  
B-12-24-1854  
D-  
HENRY RAZOR

CLARENCE OWEN WALDEN  
B-1884  
D-1913  
GERTRUDE ISHMAEL  
B-1888  
D-1968  
JAMES E. ISHMAEL  
B-1884  
D-1958  
MARY FERN ISHMAEL  
B-2-26-1910  
D-3-2-1918  
JOHN W. ISHMAEL  
B-5-22-1916  
D-2-13-1969 II  
EVERET DALE PEAYLER  
B-8-1-1914  
D-8-4-1914  
HENRY PEAYLER

WAVA J. SIGLER  
B-6-15-1919  
D-  
Richard H. SIGLER  
B-1-21-1911  
D-1-13-1977  
BETTIE H. SIGLER  
B-1884  
D-1936  
John A. SIGLER  
B-1876  
D-1932  
SON of CLARENCE ROARK  
B-3-10-1936 MR MRS  
D-3-10-1936  
JOHN A. SIGLER

THOMAS R. JOHNSON  
DAISE DAUGHTER OF J. & M.  
B-4-19-1873 JOHNSON  
D-9YRS 1 MO 17 DS.  
Body  
CLARENCE SON OF J. & M.  
JOHNSON  
B-3YRS. 8 MS.

MARY BAINSWORTH  
MARY A DRYER  
B-1-23-1832  
D-8-27-1907  
Body vault

T. GASSAWAY  
GEORGE ALLEN  
B-1844 - D-1976  
MARGARET A. McFADDEN  
B-1869 - D-1936

DENNIS SMITH  
Grand daughter  
Laverne Smith  
Grand daughter  
Dennis Brunson  
MARY E. NEWBY SMITH

NEWBY  
Body

LESTLEY EPPERSON  
L.O. TOM EPPERSON  
B-1894

HENRY E. ALVERSON  
B-1854 D-1881  
THOMAS R. ALVERSON  
CIVIL WAR  
B-1842 D-1926

D. EARNEST SMITH  
B-1878-D 1969

SARAH GASWAY  
B-4-10-1819  
D-5-17-1899  
THOMAS GASWAY  
B-1816-D 8-16-1882

ELLA JONES  
Wife of J.C. Jones  
B-4-12-1830 D-7-25-1889

HELEN L. PERRY  
B-6-17-1916

**KIMES**  
Infant B-9-27-1903  
KIMES D-9-5-1905  
B-1913-3-24 D-1913  
MILDRED B. KIMES

Body

7  
7  
7  
7  
7  
7  
7  
7  
7  
7  
SARAH DEFFENBAUGH  
9-11-1897  
D-4-5-1909  
THOMAS J. BUCKLES  
B-4-11-1836-D 3-18-1906

MARY SHELLMAN  
Wife of W.H. ROBINSON  
B-7-3-1859-D 5-17-1914  
NANCY A. SHELLMAN  
B-8-5-1826 D 4-29-1885  
Wm. SHELLMAN  
B-8-5-1802-D 4-29-1885  
THESA ROBERTSON  
B-5-1883-D 1914  
WM. SHELLMAN

NETTIE BECKHAM  
B-1-29-1876-D-  
HYLA F. BECKHAM  
B-9-1897 D-7-16-1913  
LILLIAN E. BECKHAM  
B-12-12-1905  
D-1-1-1909  
ELIZABETH J. D., 1938  
CONAWAY  
B-3-20-1857  
T. J. KARR D-3  
B-1-21-1852-1913

DOVIE his wife  
B-12-1-1870  
D-9-14-1976  
GEORGE PHELPS  
B-4-3-1871  
D-3-27-1938

TALMAGE CRUMBAUGH  
B-10-1876-D 1-11-1882

SPARKS

T. J. BUCKLES

WM. SHELLMAN

T. C. KARR

JOHN PHELPS

ARTHUR B-1905  
LEATHERS D-1974  
Jesse O. B-1903  
LEATHERS D-1969  
LOLA M. B-11-5-1909  
SCOTT  
ASA M. B-7-8-1900  
SCOTT d-12-15-1967  
LILLIE D. B-1883  
LEATHERS d-1964  
JAMES F. B-1878  
LEATHERS d-1957  
Alvie L. B-1914  
LEATHERS d-1936  
CLIFFORD J. B-1920  
LEATHERS d-1933

**BECHTEL**  
GEO. B-6-4-1849  
Bechtel D-3-31-1901  
Joseph B-29-1852  
Bechtel D-3-4-1902  
KATHERINE B-19-1821  
Bechtel D-10-28-1898  
SAMUEL B-8-15-1821  
Bechtel D-1-3-1857

**OLA DEFFENBAUGH**  
MARGRETE DEFFENBAUGH  
B-4-5-1860  
D-11-18-1893  
J. B. B-11-14-1845  
DEFFENBAUGH  
LEE OLA DEFFENBAUGH  
B-7-16-1890  
d-8-14-1967  
Susie Godsell  
1865-1917  
Wife of RALPH  
VAULT  
RALPH DEFFENBAUGH  
1866-1914  
Infant 3MS 7895,  
J.S.D. (SAMUEL)  
D-1-30-1899

**E. B. LANIER**  
CORA A. LANIER  
B-4-18-1888  
Body  
Body  
Body  
Body

WM. RIDGEWAY  
VAULT  
Body

**FRANK ETHEL**  
Body  
Body  
JONA ETHEL DAUGHTER  
B-1893-1968  
PEARL F. SIBER DAME  
B-1890-1959  
ETHEL  
ERMINNIE A. ETHEL  
B-1867-1937 (mother)  
FRANCIS A. ETHEL  
B-1865-1942 (father)  
Body  
Body

ARROY BUCKLES

Body  
Body

CATHERINE AGNES  
11-12-1898  
D-9-2-1948  
KELLY

RICHARD ALLEN KELLY  
D-9-2-1948

CLIFFORD H. PEAVLER  
B-4-9-1921  
D-9-16-1921

30'  
30'  
30'

25  
24  
23  
4  
3  
4  
3  
1  
2  
37  
36  
38

SON of H.W. + P.R. CRUMBAUGH

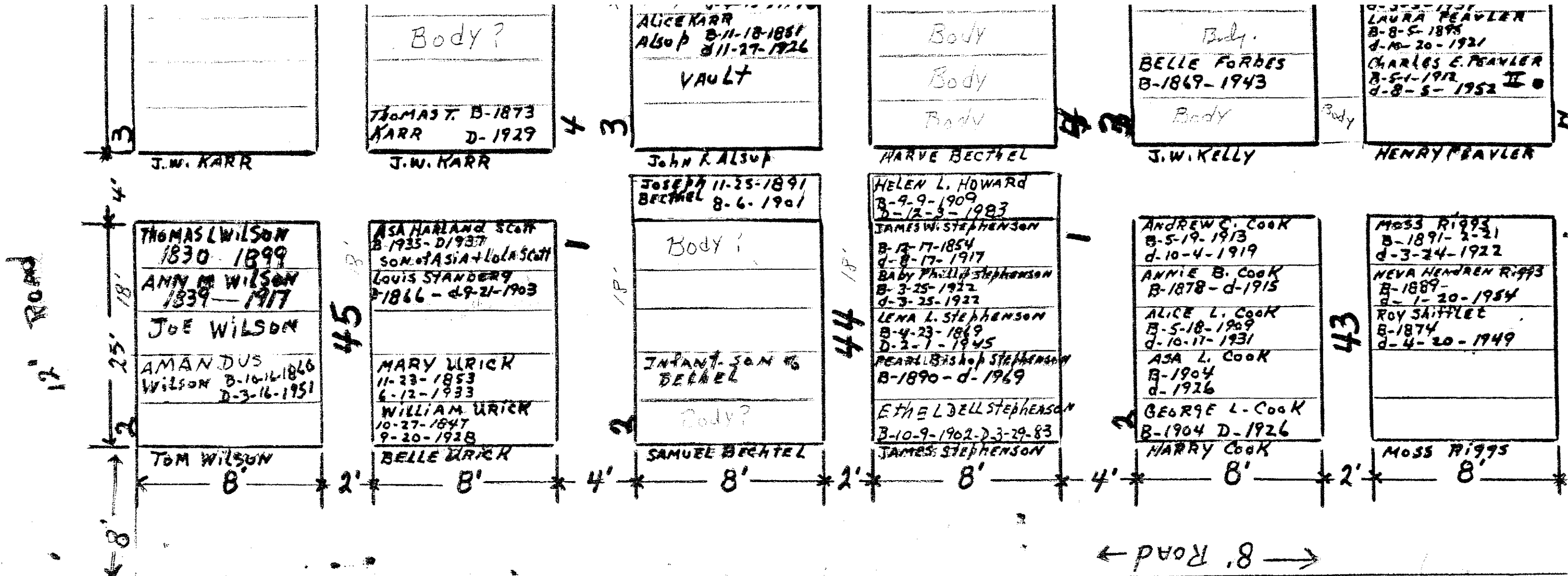

Handwritten names in a stylized, possibly mirrored or decorative font, including names like WILSON, BECHTEL, COOK, and MARY.

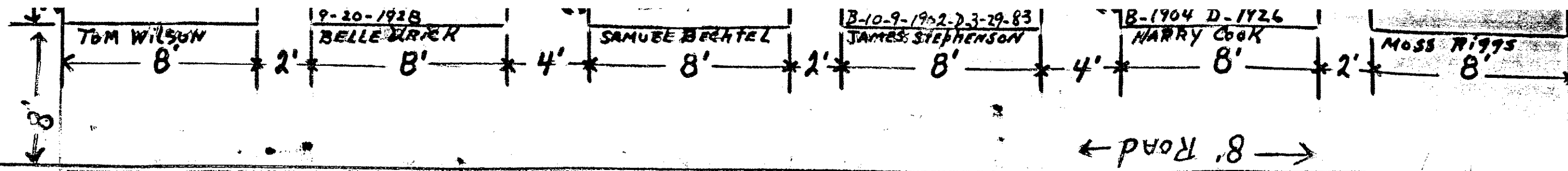

(E) (W) (C) (R) (S) (S) + (R) (L)

(L) (R) (E) (L) (E) (W) (E) (E) (E)

(E) (L)

(L) (E) (R) (L) (L) (L) (L) (L)

(L) (L)

7 4 1 0 1 0 4 7





JESS L. ROBERTSON

FRANK HENSEN

JAMES STILLS

ROY LEWIS

PETE WALKER

PETER WALKER  
B-1843  
D-1912  
**Civil**

SOLOMON WALKER  
B-1841  
D-1913  
**Civil**

FRANK SMITH

ESTELLA JAMES SMITH  
B-2-27-1907 DAU. OF F.E.  
D-6-8-1916 + IDA

FRANCIS E. SMITH  
B-1870  
D-1939

IDA M. SMITH  
B-1879  
D-1946

John Lee Smith  
B-1905  
D-1983

Lottie M. Smith  
B-1907  
D-5-20-99

Glenn L. Smith  
B-4-11-1911  
D-12-18-1989

Freda R. Smith  
B-12-23-1915  
D-

Wm. H. Sigler

WILLIAM H. SIGLER  
B-2-10-1850  
D-11-28-1931

ESTELLA R. SIGLER  
B-1-18-1860  
D-7-6-1927

LEE H. SIGLER  
B-1894  
D-1945

ESTHER C. SIGLER  
B-1894  
D-1941

A.M. ANDERSON

MARY HELEN ANDERSON  
AGE 18 MS. OLD

A. M. ANDERSON  
B-2-13-1910  
D-3-11-1985

CHARLES ANDERSON  
B-8-3-1913  
D-2-3-1983

STELLA LUE ANDERSON  
B-10-5-1902  
D-3-22-1950

ABRAHAM M. ANDERSON  
B-1869  
D-1942

WILLIE C. ANDERSON  
B-1875  
D-10-22-1956

SARAH HOWE  
B-1850  
D-1920

CARRIE REES

OLA H. COX  
B-1893  
D-1976

GEORGE W. COX  
B-1882  
D-1958

CARRIE REES VANHORN  
B-1890  
D-1943

GROVER C. REES  
B-1887  
D-1930

Body

CLARENCE OWEN WALDEN  
B-1884  
D-1913

GERTRUDE ISHMAEL  
B-1888  
D-1968

JAMES E. ISHMAEL  
B-1884  
D-1938

MARY FERN ISHMAEL  
B-2-26-1910  
D-3-2-1918

JOHN W. ISHMAEL  
B-5-22-1916  
D-2-13-1969  
**II**

EVERET DALE PEAVLER  
B-8-1-1914  
D-8-4-1914

HENRY PEAVLER

WAVA J. Sigler  
B-6-25-1919  
D-

RICHARD H. SIGLER  
B-1-21-1911  
D-1-13-1977

BETTIE H. SIGLER  
B-1884  
D-1936

JOHN A. SIGLER  
B-1876  
D-1932

SON OF CLARENCE ROARK  
B-3-10-1936 MR MRS  
D-3-10-1936

JOHN A. SIGLER

VAULT

LUCY MAE SIGLER  
B-7-27-01  
D-2-19-91

PHRASE SIGLER

JOHN H. BAILEY  
B-1888 - D-11-30-1959

ROBERT BAILEY  
B-11-14-1823  
D-3-29-1903  
**Civil**

ADELINE BROWNING BAILEY  
B-3-17-1835  
D-10-10-1876

ROBERT BAILEY

MADGE STARR  
B-1911 DAU. OF E. J. STARR  
D-1912

FORREST STARR

ELLEN P. STARR  
B-1881  
D-1962 WRC

JOHN W. STARR  
B-1874  
D-1932

JOHN STARR

NEWBY

LESTLEY EBBERSON

SAM HOLLAND

FRANK BROWN

JERRY MURPHY

AMANDA J. JONES  
B-12-16-1848 his wife  
D-5-4-1927

JEREMIAH MURPHY  
B-6-13-1850  
D-10-5-1926

John H. Holland  
B-1850 - D-1936

BUNDA A. HOLLAND

FRANK BROWN  
D-12-8-1920

18

19

20

187

[Blank box]

HELEN EPPERSON  
B-6-17-1916  
D-

MARY L. HOLLAND  
B-1877  
D-1946  
SAMUEL L. HOLLAND  
B-1873  
D-1949

MARIE DUNLAP  
ALICE DUNLAP  
B-2-3-1941  
D-3-30-1944

[Blank box]

7  
8

914  
MAN  
71585

NETTIE BECKHAM  
B-1-29-1876-D-  
HYLA F. BECKHAM  
B-9-1897-D-7-16-1913  
LILLIAN E. BECKHAM  
B-12-12-1905  
D-1-1-1967  
ELIZABETH J. D. 1938  
CONWAY  
B-3-20-1857  
C. J. KARR D-3  
B-1-21-1852-1915

23

DOVIE his wife  
B-12-1-1870  
D-9-14-1976  
GEORGE PHELPS  
B-4-3-1871  
D-3-27-1938

JOHN PHELPS

WESTLEY ECHOLS son of  
B-12-29-1916 G.+D.  
D-1-4-1917 ECHOLS  
RACHEL ECHOLS DAUGHTER  
B-9-30-1919 G.+D.  
D-11-2-1919 ECHOLS  
PAUL EDWARD SIGLER  
B-8-4-1928  
D-11-10-1971

KOREA  
JAMES ECHOLS

22

HOSLER TWINS - 1919  
HOSLER ELMO & SUSAN CHILDREN  
M. SUSAN HOSLER  
1890-1967  
ELMO A. HOSLER  
1886-1964  
Virginia Sandage  
B-5-16-21  
D-8-21-98  
LINDA ELLEN  
D-3-5-1951  
DAUGHTER OF SANDAGE

E.E. HOSLER

O.J. HOOVER  
B-1848  
D-1922  
BEULAH HOOVER MATLOCK  
B-1888-  
D-1963  
BERT P. MATLOCK  
B-1894  
D-1964  
KENNETH EUGENE MATLOCK  
B-9-4-1922  
D-10-5-1924  
LAWRENCE R. MATLOCK  
B-11- -48  
D-11- -48

BERT MATLOCK

21

JOHN H. BAILEY  
B-1889  
D- VAULT  
MAGGIE J. BAILEY  
B-1890  
D-1948  
MARY ELIZABETH MORRIS  
B-1871  
D-1936

JOHN BAILEY

ON  
140  
AN

4 3

T. C. KARR

R  
15  
pob

1 2

Wm. RIDGEWAY  
VAULT  
Body

FRANK ETHEL  
Body  
Body  
JONA ETHEL DAUGHTER  
B-1893-1968 ETHEL  
PEARL F. SIGER DAUGHTER  
B-1890-1959 ETHEL  
ERMINNIE A. ETHEL  
B-1867-1937 (mother)  
FRANCIS A. ETHEL  
B-1865-1942 (father)  
Body  
Body

38

RICHARD ALLEN KELLY  
D-9-2-1948

CLIFFORD H. PEAVLER

Body  
VAULT  
EVER GREEN VAULT  
Body  
Body  
MARY MARTIN SHORT  
B-1892-1918  
VIRGIL SHORT

ANNA L. GAREE  
B-1872-1952  
ELMER G. GAREE

39

CHAS. MARTIN  
B-1890-1930  
NATTIE E. DUDGSON  
B-1895-1961  
ROBERT L. DUDGSON  
B-1903-1974  
EVELYN A. JOHNSON  
B-1874-1952  
JAMES A. JOHNSON  
B-1871-1957  
NATTIE MARTIN

Body?  
Body?

1 2

JESSIE MATLOCK  
B-1891-1966  
ELLA M. MATLOCK  
B-1867-1929  
INFANT SON of Carl Matlock  
D-11-2-1948  
GEO. P. MATLOCK  
B-1865-1929  
ELLA MATLOCK

ANDREW DEFFENBAUGH  
B-1900-1940

40

DON WINGET  
9/2/74 - 2/13/95  
RODA C. PEAVLER  
B-1863-d1935  
JOHN PEAVLER  
1860-1946  
JOHN PEAVLER

INFANT SON of TOM DYE  
B-1936  
D-1936  
ANDREW C. DYE  
B-1-30-1889  
D-4-4-1936

tree

Belly  
 BELLE FORBES  
 B-1869-1943  
 Body

J.W. KELLY

Laura PEAVLER  
 B-8-5-1895  
 d-M-20-1921  
 CHARLES E. PEAVLER  
 B-5-1-1912  
 d-8-5-1952 II

HENRY PEAVLER

CALLA LEE WHITSALL  
 B-1887-1958  
 LEON WHITSALL  
 B-1880-1946  
 CHARLEY WHITSALL  
 B-1908-1945

CHAS. DAVIS

VAULT

JOHN KARR

WARD BETTEN DASH  
 B-1872-1945

WARD BETTEN DASH

GRACE ELLEN DYE  
 B-8-18-1918  
 d-12-31-1953  
 Josephine Edith DYE  
 B-2MS. old - 1937

ANDREW J. DYE

ANDREW C. COOK  
 B-5-19-1913  
 d-10-4-1919  
 ANNIE B. COOK  
 B-1878-d-1915  
 ALICE L. COOK  
 B-5-18-1909  
 d-10-17-1931  
 ASA L. COOK  
 B-1904  
 d-1926  
 GEORGE L. COOK  
 B-1904 D-1926  
 HARRY COOK

43

MOSS R1995  
 B-1891-2-21  
 d-3-24-1922  
 NEVA HEANDREN R1993  
 B-1889-  
 d-1-20-1954  
 ROY SAFFLET  
 B-1874  
 d-4-20-1949

MOSS R1995

HATTIE BAILEY  
 B-10-8-1876  
 d-3-1-1933  
 CHAS. C. BAILEY  
 B-1869-  
 d-9-9-1949  
 MISS FLOSSIE BAILEY  
 B-5-6-1903  
 d-4-12-1968  
 ROSCO BAILEY  
 B-8-12-1907  
 d-4-12-1963  
 Wm. WELLS  
 B-1856  
 d-1935  
 CHAS. BAILEY

42

SUSAN J. WILLIAMSON  
 B-1888-d-1967  
 MCLAN WILLIAMSON  
 B-1885-d-1933  
 DORIS W. HAWICE  
 B-3-18-1918  
 d-1939  
 SUSAN WILLIAMSON

SUSAN WILLIAMSON

DEWY (Doc) HART  
 B-1904-d-1971  
 Wm. WRAY  
 D-5-27-1943  
 Body

41

BARBARA MAEN HART  
 B-1881-  
 d-7-8-1957  
 LEE HART  
 B-8-1-1877  
 d-5-17-1937  
 CARLEY E. HART  
 B-9-1-1921  
 d-2-5-1970  
 HESSIE D. HART  
 B-2-3-1908  
 d-10-24-1943  
 Body

Body



← 8' Road →

INFANT of  
 ROSCO BAILEY

Handwritten names in a stylized, decorative font, arranged in three rows. The names appear to be: Row 1: J. W. KELLY, ANNIE B. COOK, ALICE L. COOK, ASA L. COOK, GEORGE L. COOK, HARRY COOK, MOSS R1995, NEVA HEANDREN R1993, ROY SAFFLET, CHAS. C. BAILEY, MISS FLOSSIE BAILEY, ROSCO BAILEY, Wm. WELLS, CHAS. BAILEY, SUSAN J. WILLIAMSON, MCLAN WILLIAMSON, DORIS W. HAWICE, SUSAN WILLIAMSON, DEWY (Doc) HART, Wm. WRAY, BARBARA MAEN HART, LEE HART, CARLEY E. HART, HESSIE D. HART. Row 2: BELLE FORBES, HENRY PEAVLER, CALLA LEE WHITSALL, LEON WHITSALL, CHARLEY WHITSALL, CHAS. DAVIS, JOHN KARR, WARD BETTEN DASH, ANDREW J. DYE. Row 3: (Faint names, possibly including the names from the first row).